

Panasonic

Closed Circuit Video Equipment

Vandal Proof
Super Dynamic II Colour Camera
(with Low-Light B/W Mode)

WV-CW474F

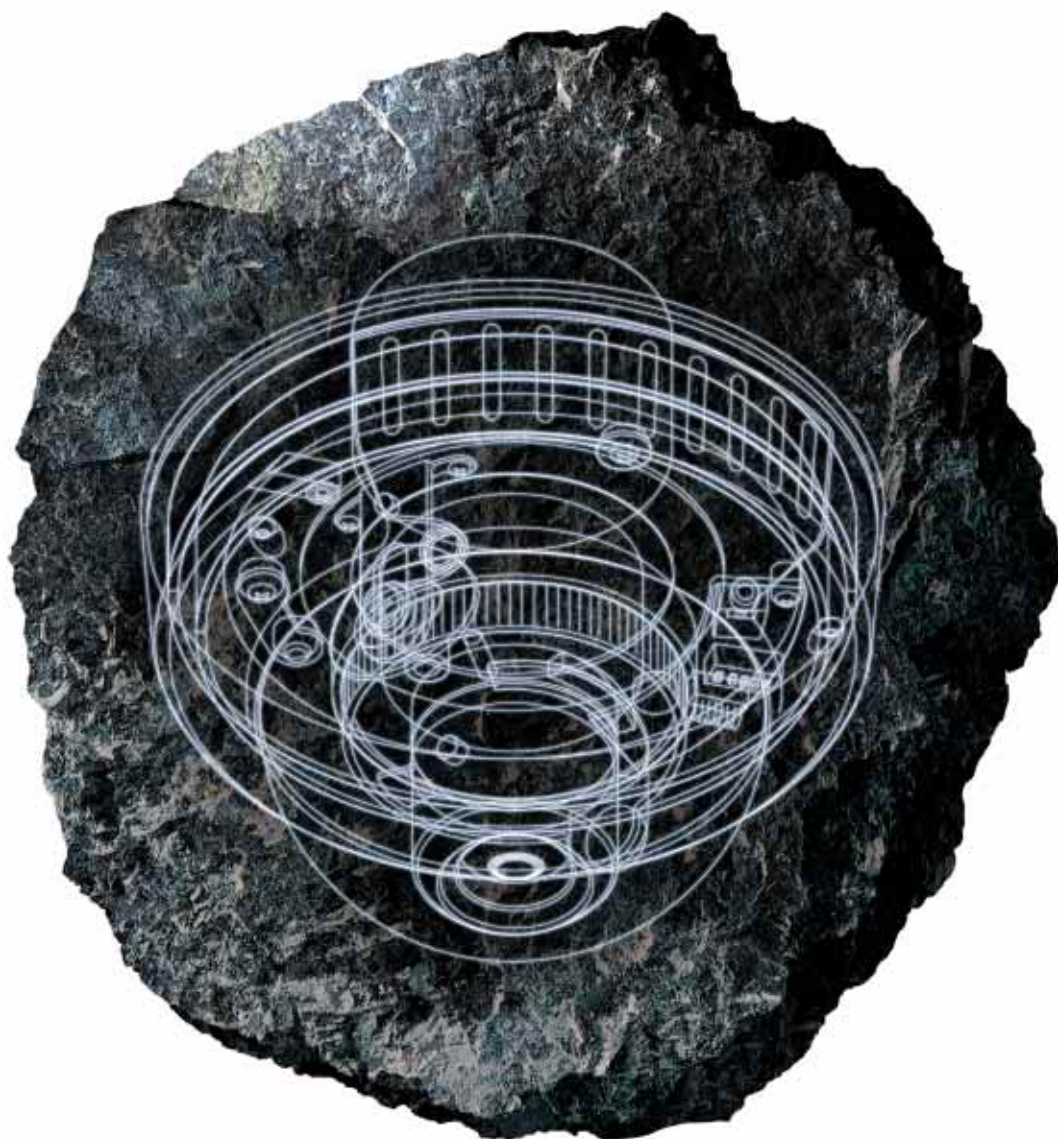

The Easy to Install

•

Vandal Proof

•

Weather Proof

•

Camera Solution

Heavy Duty Construction



**Actual
Size**

Die-cast aluminum body Shock Resistant

With a body made of die-cast aluminum and a dome made of 3.5mm thick polycarbonate, these cameras are tough enough to resist severe shocks.



The camera lens unit has a spring structure, so the chassis can withstand external shocks.



IP66 approved Rain and Wind Resistant

Meet IP66 international standards. With excellent dust and moisture resistant capabilities these cameras can be used outdoors, under building eaves.



High Performance in a Rugged Body. New Vandal Proof Camera Makes its Debut.

Panasonic's new Vandal Proof Type Super Dynamic II Colour Camera. The WV-CW474F is not only rugged and loaded with high-performance features, it is also easy to install. Highly resistant to dust, moisture and shock this unit satisfy international standards. The WV-CW474F includes high image quality, increased sensitivity, day/night switching for 24-hour surveillance and a multi-function motion detector. Free from conventional limitations on placement, application and objective, this multipurpose colour camera is ideal for numerous surveillance applications.

Feature Loaded Simple to Install

Feature Loaded & Simple to Install

For single-camera 24-hour surveillance Day/Night Switching

Unlimited attachment with Unlimited Positioning 3-Dimensional Hinges

Senses motion and sends alarm signal Motion Detector

80 times dynamic range Super Dynamic II

Day

Night

Single-camera 24-hour surveillance Day/Night Switching

To allow 24-hour surveillance, this camera (in high-sensitivity mode) senses darkness and switches automatically from daytime colour to nighttime black-and-white with duration and timer setting to meet exact installation requirement. It can also be switched from colour to black-and-white manually.

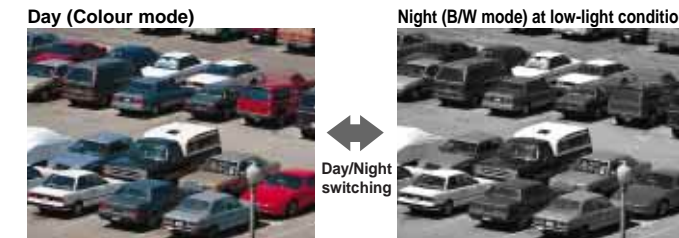

Full-colour images at 0.8lx* Black-and-white images at 0.1lx*

This camera supports full-colour surveillance in low-light situations like this parking lot, switching to black-and-white allows surveillance in light as low as 0.1lx with optional clear dome cover; WV-CW1C. IR response down to 0.00lx is valid. 10x auto electronic sensitivity up is also supported (in fixed mode 32x available).

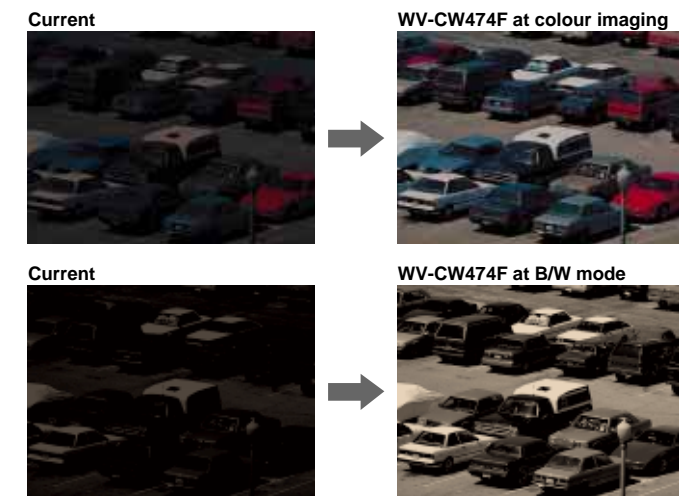

*With optional clear dome cover; WV-CW1C

2x variable-focal lens is standard equipment

Equipped with a 2x variable-focal lens plus an additional 2x electronic zoom, this camera can view its subjects in greater details.

With Super Dynamic II, backlighting is no problem

With a 80 times dynamic range, Panasonic's proprietary Super Dynamic II processing yields clear images even in high-contrast or backlit lighting situations.

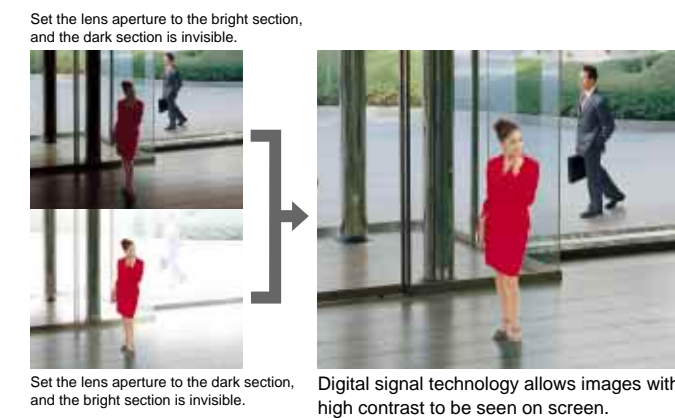

Digital Motion Detector senses movement and sends the alarm signal

When the Motion Detector senses movement in the monitored image, it automatically sends alarm signal to the system. When linked to a VTR, it provides an efficient way to avoid missed images.

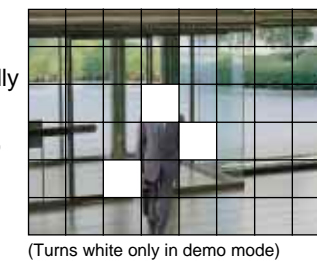

Character displays title

The monitor can display title up to 16 roman letters or numbers. By allowing instant identification of pre-set camera locations, this feature can help prevent errors during emergency situations.



The above all photographs were taken for the purpose of this explanation; actual images may differ.

Proprietary 3-D hinge makes adjustments easy

The 3-dimensional hinge (Pan, Tilt and Azimuth) allows the camera to be rotated as well as moved horizontally and vertically. Digital signal processing allows the image itself to be shifted up, down, left, right, or inverted. Choose precisely the camera angle you need; no camera makes it easier.

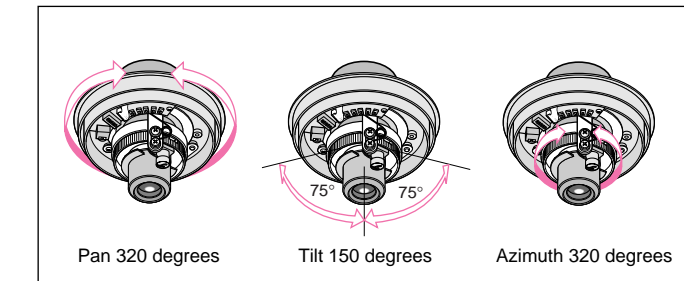

Basic settings couldn't be simpler

Simple dipswitches control Soft/Sharp, Day/Night: Off/Auto and other basic settings. A compact monitor-out terminal with a small liquid crystal display allows you to check settings on the spot.



Easily installs in existing electronic junction box

The flush mount body can be installed in existing two gang junction box.



SYSTEM EXAMPLE

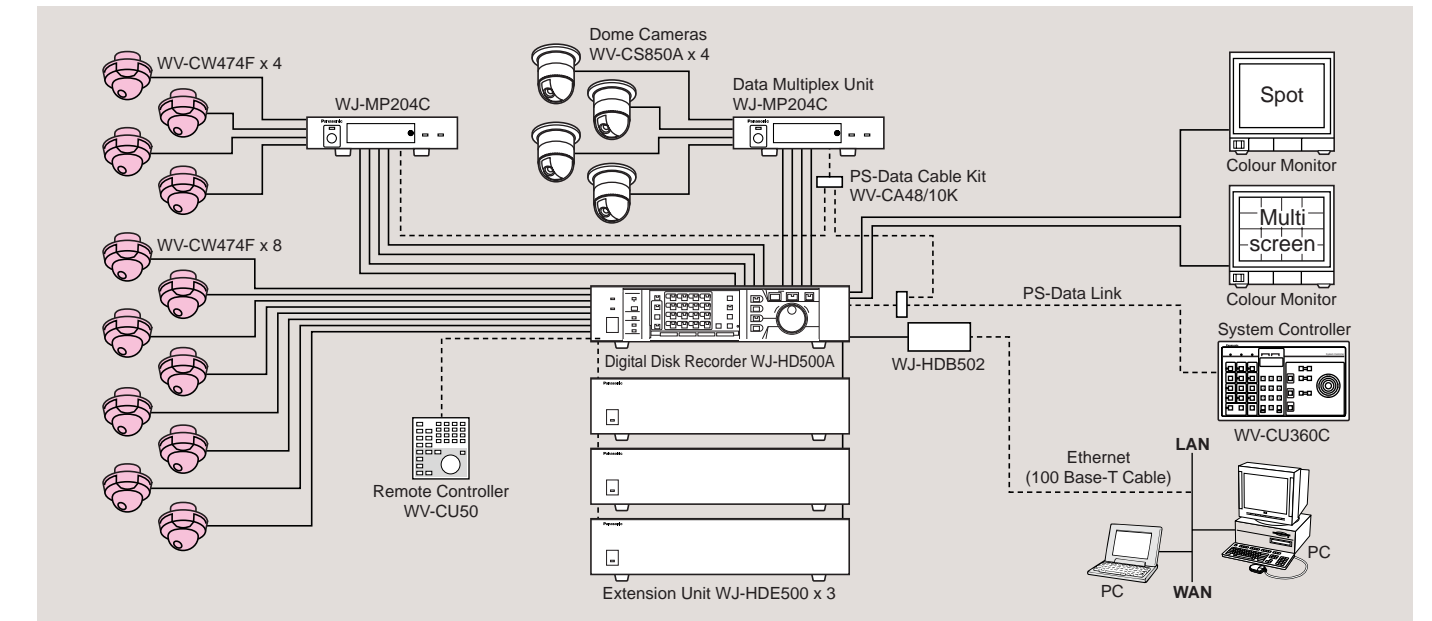

SDII

Super Dynamic



Shown WV-CW474F with optional mounting base; WV-Q12 for surface installation.

480-line horizontal resolution in colour mode, and 570-line in B/W mode

Equipped with a powerful 753(H) x 582(V) 1/3-type CCD, this camera delivers beautifully clear images with 480-line horizontal resolution at colour imaging and 570-line at B/W mode.



- at Hospital/Day Care Centre
- at Low Court
- at Prison
- at Ware house
- and more facilities

MAJOR OPERATING CONTROLS

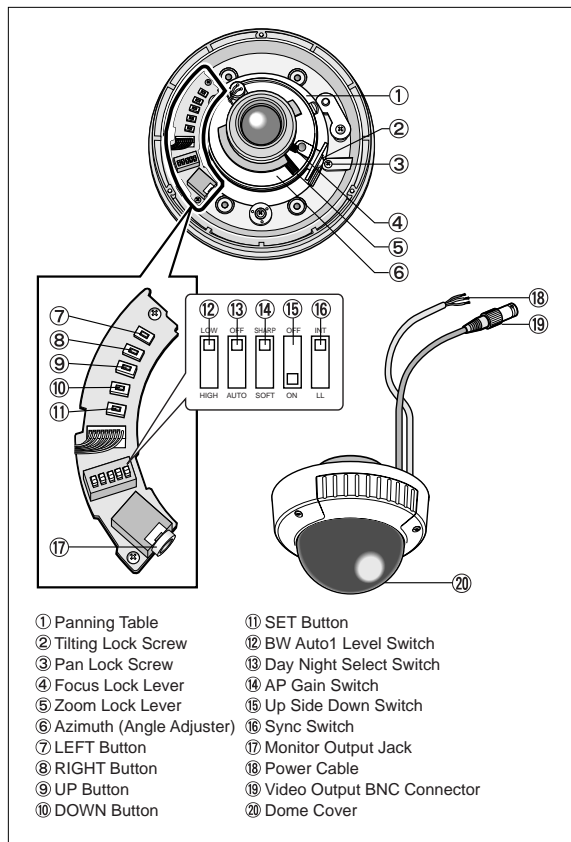

OPTIONAL COMPONENTS & ACCESSORIES

Mounting Base WV-Q112 	Clear Dome Cover WV-CW1C 
Digital Video Duplex Colour Multiplexers WJ-FS616C (16ch) 	Data Multiplex Unit WJ-MP204C PS·Data 
WJ-FS409 (9ch) WJ-FS416 (16ch) PS·Data 	System Controller WV-CU360C PS·Data 
MATRIX SYSTEM500 Matrix Switcher WJ-SX550C Card Cage WJ-AD550 System Controller WV-CU550CJ 	Digital Disk Recorder with 16ch Multiplexer WJ-HD500A PS·Data 
Digital Disk Recorder WJ-HD100 PS·Data 	
Colour Monitors WV-CM2080 55cm CRT WV-CM1780 45cm CRT WV-CM1480 40cm CRT WV-CM1420 37cm CRT WV-CM1020 25cm CRT	
PS·Data	PS·Data

SPECIFICATIONS

Type	Flush mount type
Pick Up Device	753 (H) x 582 (V) pixels, interline transfer CCD
Scanning Area	4.8 (H) x 3.6 (V) mm, (Equivalent to 1/3" tube)
Scanning	625 lines / 50 fields / 25 frames
Scanning System	2 : 1 interlace
Synchronization	Internal / Line-Lock / VD2
Video Output	VBS 1.0V [p-p] / 75 Ω / PAL composite signal / BNC connector
Resolution	Horizontal: 480 lines at colour imaging mode, 570 lines at B/W mode (at centre) Vertical: more than 400 lines (at centre)
Minimum Illumination (at F1.4 Wide)	2.4 lx at colour imaging mode 0.3 lx at B/W mode 0.8 lx at colour imaging mode, with optional dome cover; WV-CW1C 0.1 lx at B/W mode, with optional dome cover; WV-CW1C
Signal to Noise Ratio	50dB (at AGC Off, Weight On, AP On)
Dynamic Range	48dB (typical)
Functions	Camera Title: 16 character display (alphabet, numeric, symbols) Light Control: ALC mode Super Dynamic II: On / Off Electronic Shutter: Off, 1/120, 1/250, 1/500, 1/1,000, 1/2,000, 1/4,000, 1/10,000 sec. AGC: On (DNR-H) / On (DNR-L) / Off Electronic Sensitivity Up: Off, Auto (x2, x4, x6, x10), Fix (x2, x4, x6, x10, x16, x32) White Balance: ATW 1 / ATW 2 / AWC Motion Detector: On / Off
Lens	Type: 2x variable focal lens Focal Length: 3.8 ~ 8.0 mm Aperture Ratio: F1.4 (Wide) to F176, close / F1.8 (Tele) to F176, close Min. Object Distance: 1.2 m - ∞
Power Source	24V AC, 50Hz
Power Consumption	4.6W
Ambient Operating Temperature	-10°C ~ +50°C
Dimensions (D) x (H) (mm)	ø152.5 x 133
Weight (approx.)	1.0 kg

APPEARANCE

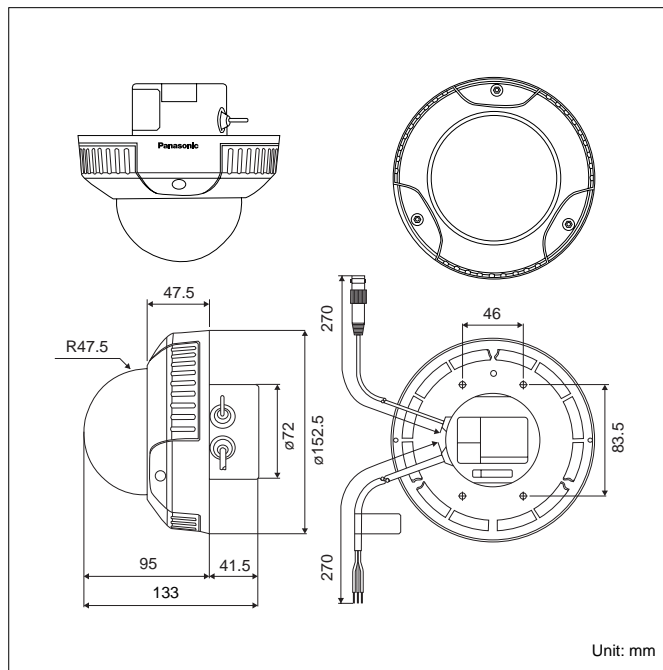

• All TV pictures are simulated. • Weights and dimensions are approximate. • Specifications are subject to change without notice. • These products may be subject to export control regulations.

DISTRIBUTED BY:

AV & Security Company
Matsushita Communication Industrial Co., Ltd.
 600 Saedo-cho, Tsuzuki-ku, Yokohama, 224-8539, Japan
 Tel 81(0)45-939-1841
 Fax 81(0)45-934-9802
 URL
<http://www.mci.panasonic.co.jp/english/prdct/cctv/index.html>

Panasonic

Panasonic is the brandname of Matsushita Electric.
 Printed in Japan WV-JKCW474C (2N-692)